

REMOVAL

1. **PRECAUTION**
CAUTION:
 Read "PRECAUTION" thoroughly before servicing (See page [RS-1](#)).
2. **DISCONNECT CABLE FROM NEGATIVE BATTERY TERMINAL**
CAUTION:
 Wait for at least 90 seconds after disconnecting the cable to prevent the airbag from working.
3. **REMOVE INSTRUMENT PANEL SUB-ASSEMBLY**
HINT:
 Refer to the procedures up to "REMOVE INSTRUMENT PANEL SUB-ASSEMBLY" (See page [IP-9](#)).
4. **DISCONNECT INSTRUMENT PANEL WIRE ASSEMBLY**
 - (a) Remove the 3 clamps.
 - (b) Disconnect the 2 connectors from the front passenger airbag assembly.
5. **REMOVE NO. 1 SIDE DEFROSTER NOZZLE DUCT** (See page [IP-19](#))
6. **REMOVE DEFROSTER NOZZLE ASSEMBLY** (See page [IP-20](#))
7. **REMOVE FRONT PASSENGER AIRBAG ASSEMBLY**
 - (a) Remove the 2 screws.

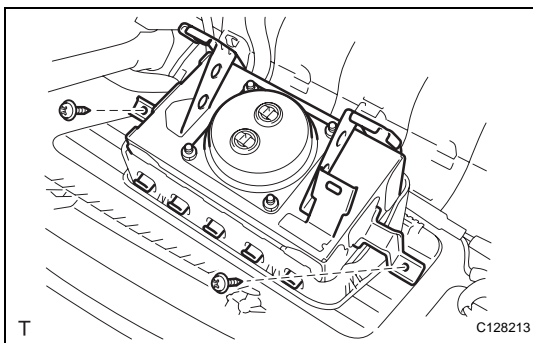

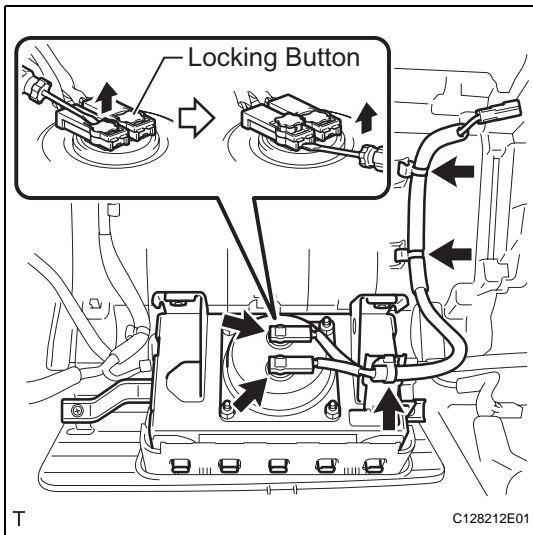
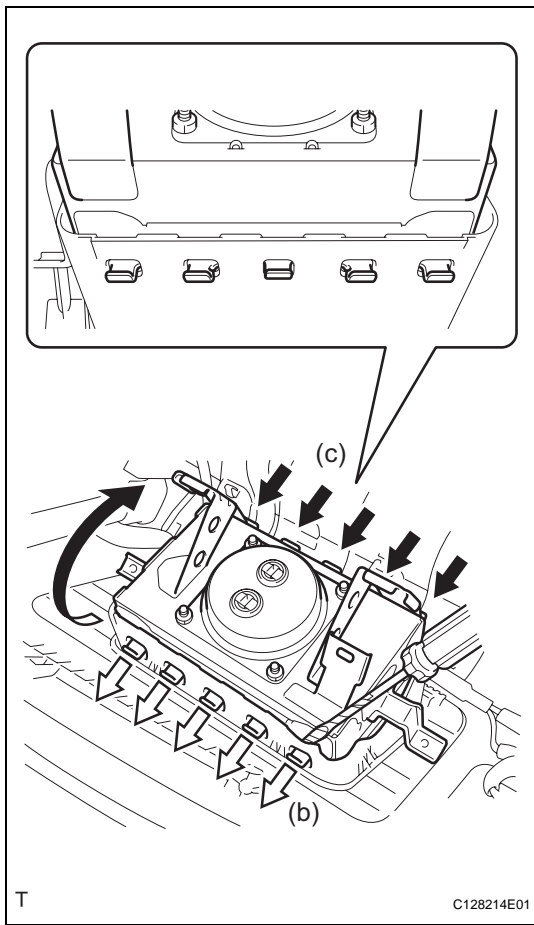

- (b) Using a screwdriver (with its tip wrapped in protective tape), disengage the 5 hooks from the instrument panel and turn the front passenger airbag assembly in the direction indicated by the arrow shown in the illustration.
- (c) Disengage the 5 hooks and remove the front passenger airbag assembly from the instrument panel.

RS

T

C128214E01